

Note: This archival plan is provided as a study plan only and may not be suitable for construction without modification, and may not be appropriate for all locales. Code officials and other authorities should always be consulted before any construction is attempted.

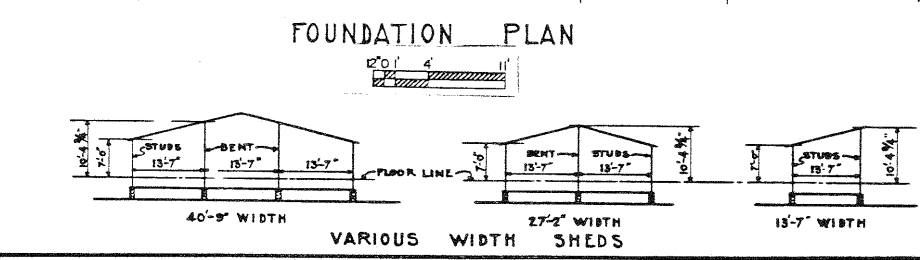
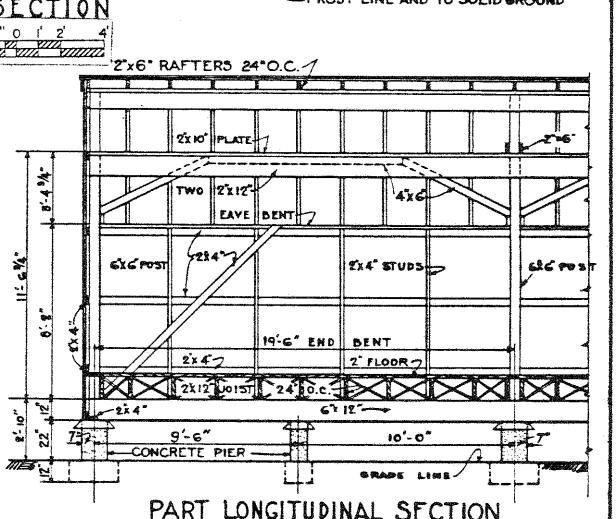
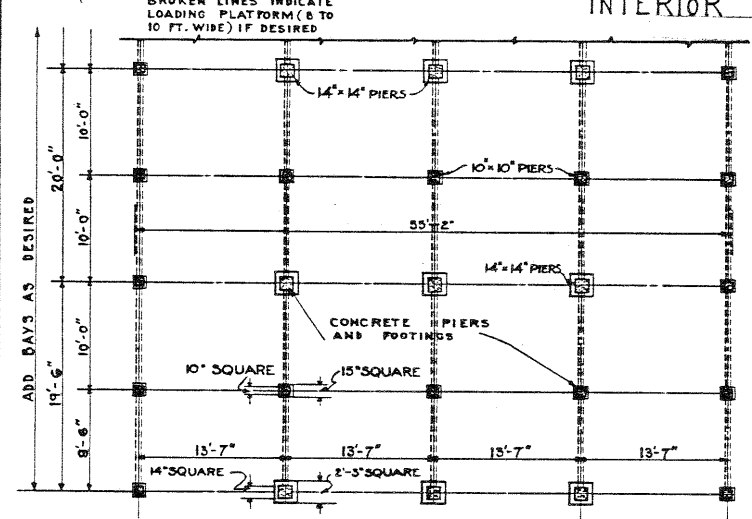
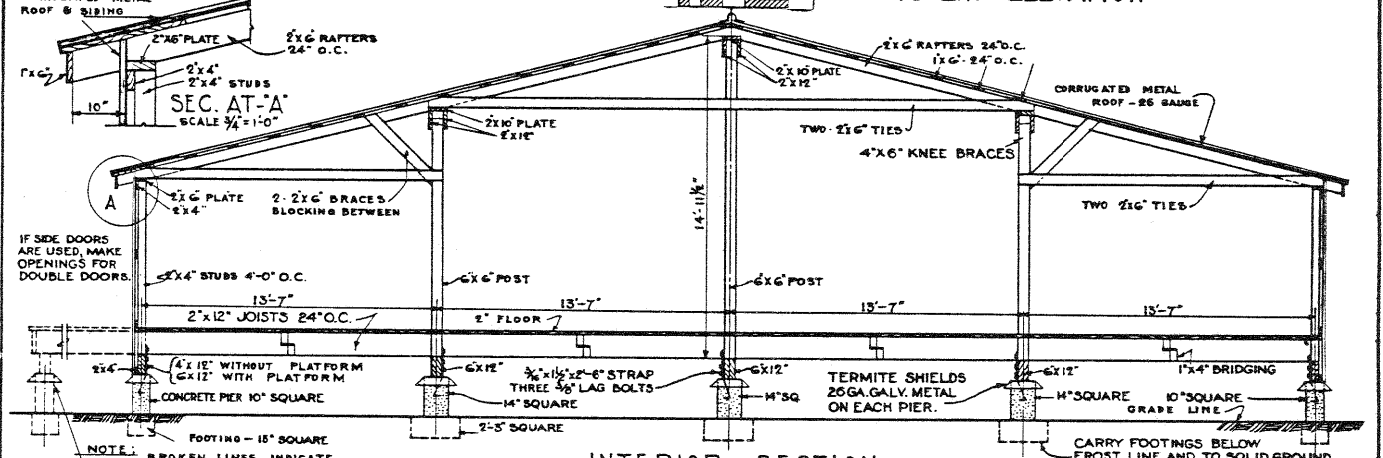
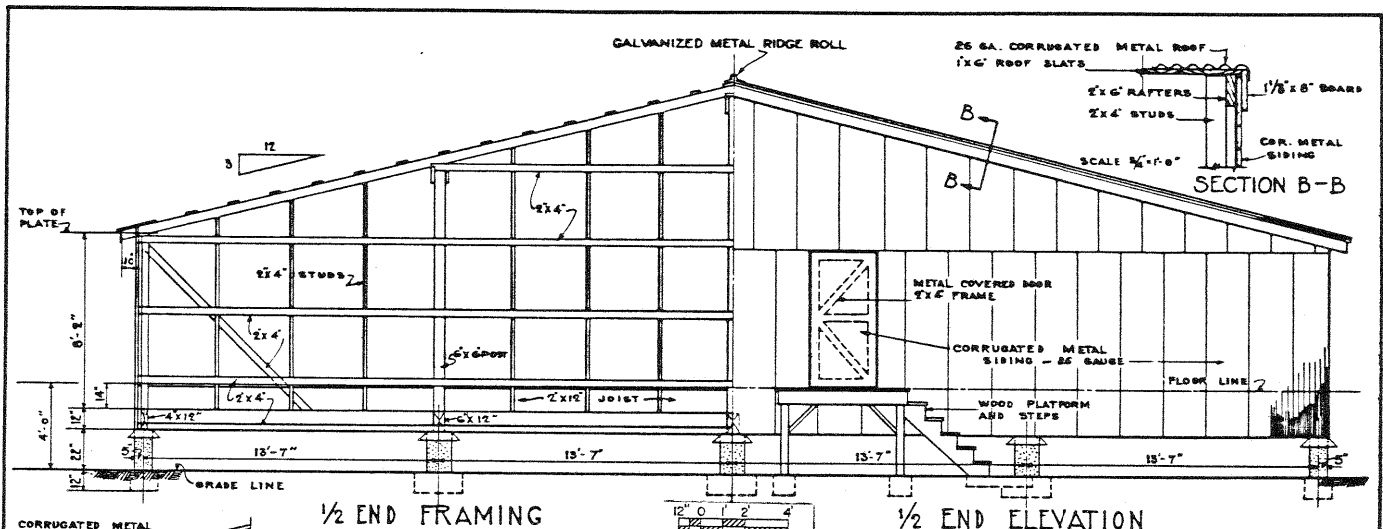

U.S. DEPARTMENT OF AGRICULTURE	
BUREAU OF AGRICULTURAL ENGINEERING	
DIVISION OF STRUCTURES	
COTTON SHED	
Scale as noted	CHECKED
Designed by - T.A.M.M.	SHEET 1 OF 18 SHEET
Traced by - M.J.L.	SERIAL NO.
Approved	3050