

PERSPECTIVE

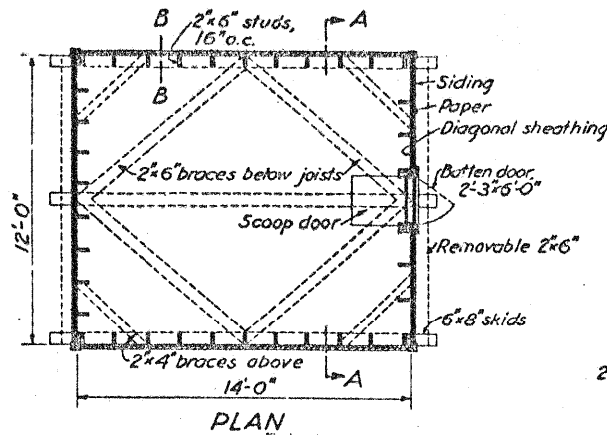

PLAN

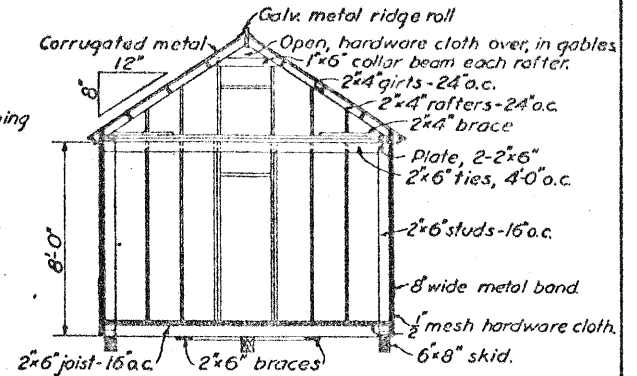

SECTION A-A

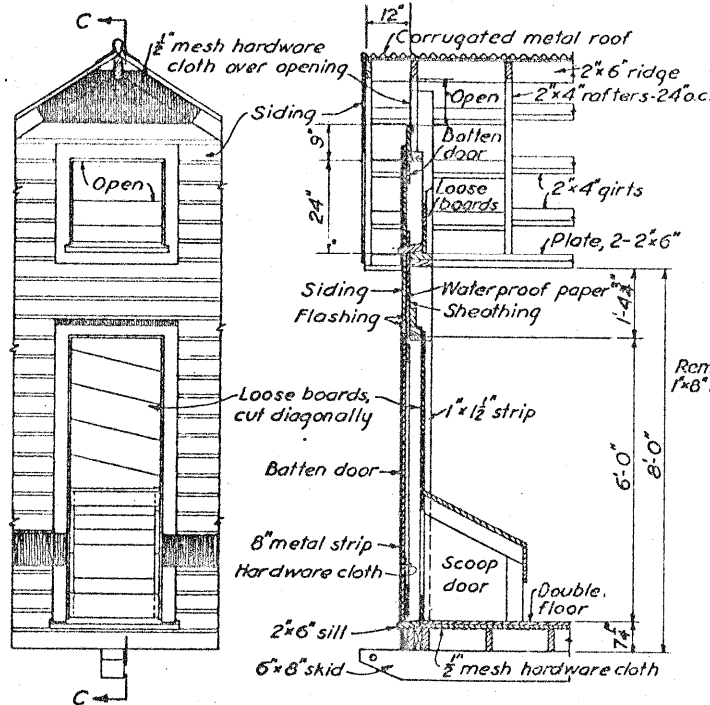

ELEVATION

Batten door not shown.

SECTION "C-C"

DOOR DETAILS

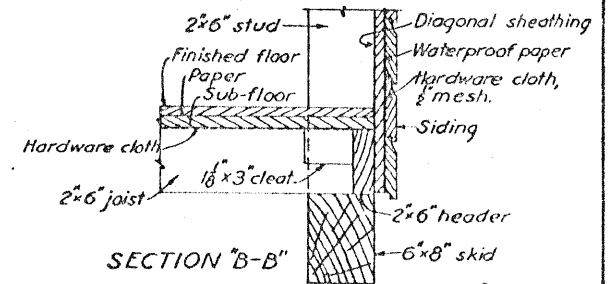

SECTION "B-B"

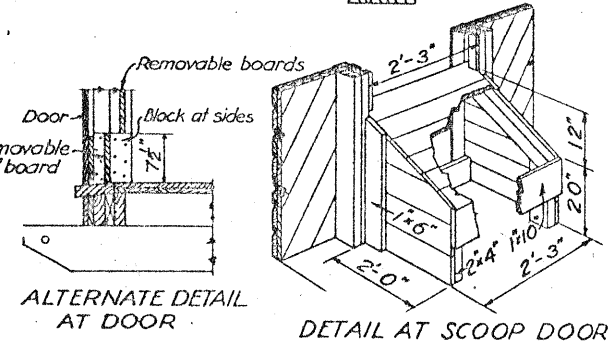

ALTERNATE DETAIL AT DOOR

DETAIL AT SCOOP DOOR

- BILL OF MATERIAL**
- 3 - 6x8x16'-0" - skids.
 - 24 - 2x6x16'-0" - studs and ridge
 - 4 - 2x6x14'-0" - side plates.
 - 22 - 2x6x12'-0" - joists, ties, spreaders, & end plates.
 - 4 - 2x6x10'-0" - braces.
 - 20 - 2x4x16'-0" - rafters, girts, braces etc.
 - 120 - lin. ft. 1 1/2x4" - corner boards, trim, and casing.
 - 50 - lin. ft. 1 1/2x4" - corner boards and cleats.
 - 600 ft. B.M., T. & G. - sheathing - walls, sub-floor, etc.
 - 250 ft. B.M., T. & G. - flooring - finished floor and doors.
 - 600 ft. B.M. - drop siding.
 - 3 - 216 ft. rolls - waterproof building paper.
 - 2 - 2x6" - door sills.
 - 16 pieces - 26 ga. - corrugated metal, 8'-0" long - roof.
 - 16 lin. ft. - metal ridge roll.
 - 290 sq. ft. 1/2" mesh - hardware cloth.
 - 60 lin. ft. - 28 ga. - galv. metal strips - 8" wide.
 - 3 - 6" Tee hinges.
 - 2 - 4" Tee hinges.
 - 2 - Hasps.

Nails, paint, and log sills not included in above list

U.S. DEPARTMENT OF AGRICULTURE		
BUREAU OF AGRICULTURAL CHEMISTRY AND ENGINEERING		
FARM STRUCTURES RESEARCH DIVISION		
GRANARY		
Scale: As shown	CHECKED	SHEET 1 OF 1
Drawn by: G.L.E.		
Traced by: W.F.		
Approved:		SERIAL NO. 5531

CAPACITY-1000 BUSHELS

Note:

This archival plan is provided as a study plan only and may not be suitable for construction without modification, and may not be appropriate for all locales. Code officials and other authorities should always be consulted before any construction is attempted.