

• PERSPECTIVE •

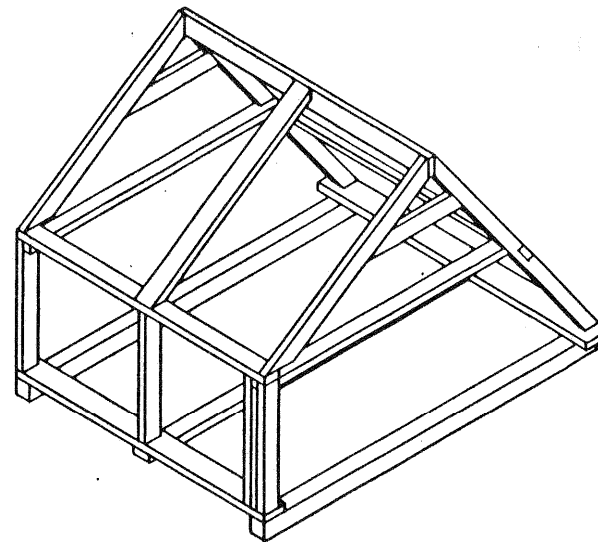

• ISOMETRIC VIEW OF FRAMING •

NOTE:
 SIZE SHOULD BE INCREASED TO 8" X 8" FOR LARGE
 BOWS. USE 4 RAFTERS & 4 STUDS ON FRONT & 2 TIES
 UNDER FLOOR.

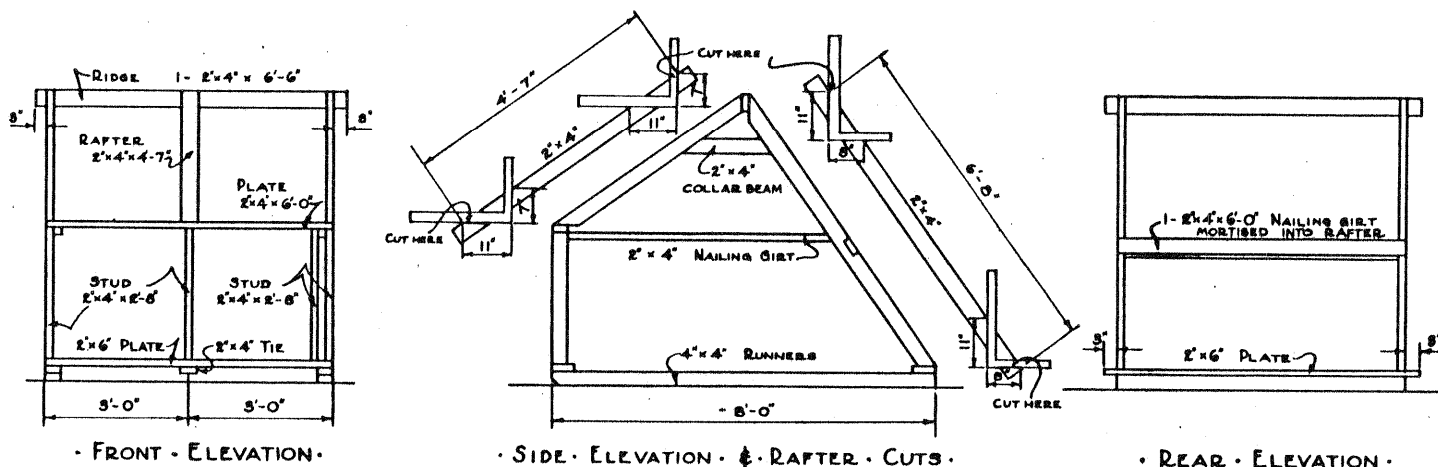

• DETAILS OF FRAMING •

• MATERIAL LIST •

No.	SIZE	PURPOSE
2	4" x 8" - 0"	RUNNERS
1	2" x 6" - 6" - 0"	FRONT SILL
1	2" x 6" - 6" - 6"	REAR SILL
1	2" x 4" - 6" - 6"	RIDGE
4	2" x 4" - 6" - 0"	PLATE & GIRTS
4	2" x 4" - 2" - 8"	STUDS
1	2" x 4" - 8" - 0"	FL. BRACE
2	2" x 4" - 6" - 8"	BACK RAFTERS
3	2" x 4" - 4" - 7"	FRONT RAFTERS
2	2" x 4" - 1" - 10"	COLLAR BEAM
15	1" x 6" - 12" - 0"	ROOF
14	1" x 6" - 8" - 0"	SIDING (FRONT)
3	1" x 6" - 12" - 0"	" (ENDS)
7	1" x 6" - 10" - 0"	" (")
7	1" x 6" - 8" - 0"	" (")
11	1" x 10" - 6" - 0"	FLOOR
2	1" x 4" - 10" - 0"	DOOR CLEATS

1 PAIR 6" T-HINGES
 1 " 8" T-"
 1 HASP WITH SCREWS
 3 lbs. 16d NAILS
 2 " 6d "
 3 " 8d "

Note:

This archival plan is provided as a study plan only and may not be suitable for construction without modification, and may not comply with local building codes. Code officials and other authorities should always be consulted before any construction is attempted.