

BILL OF MATERIALS		
PART NO	LUMBER AND SIZE OF MATERIAL	STANDARD STOCK TO CUT MATERIAL FROM
1	6 PC. 2x4x2'-6"	2 PC. 2x4x8'-0"
2	2 PC. 2x4x5'-8"	
3	4 PC. 2x4x5'-8"	3 PC. 2x4x12'-0"
4	26 PC. 1x6x2'-0"	7 PC. 1x6x8'-0"
5	4 PC. 1x6x5'-6"	6 PC. 1x6x12'-0"
6	8 PC. 1x6x5'-4"	1 PC. 2x6x10'-0"
7	2 PC. 2x6x5'-0"	6 PC. 1x6x14'-0"
8	12 PC. 1x6x6'-0"	CUT FROM ROLL
9	2 PC. 36" T/O ROOFING	
10	4 1/2 x 4 1/2 MACHINE BOLTS	
11	8 1/2" FLAT WASHERS	
12	5# 8d NAILS	
13	2* 16d NAILS	
14	1# ROOFING NAILS	

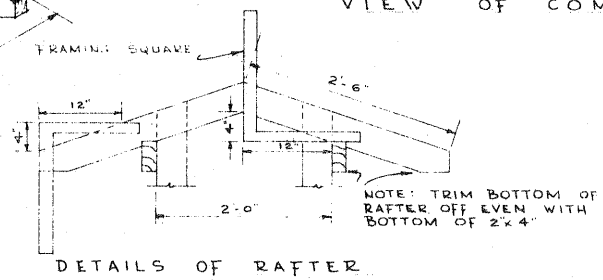
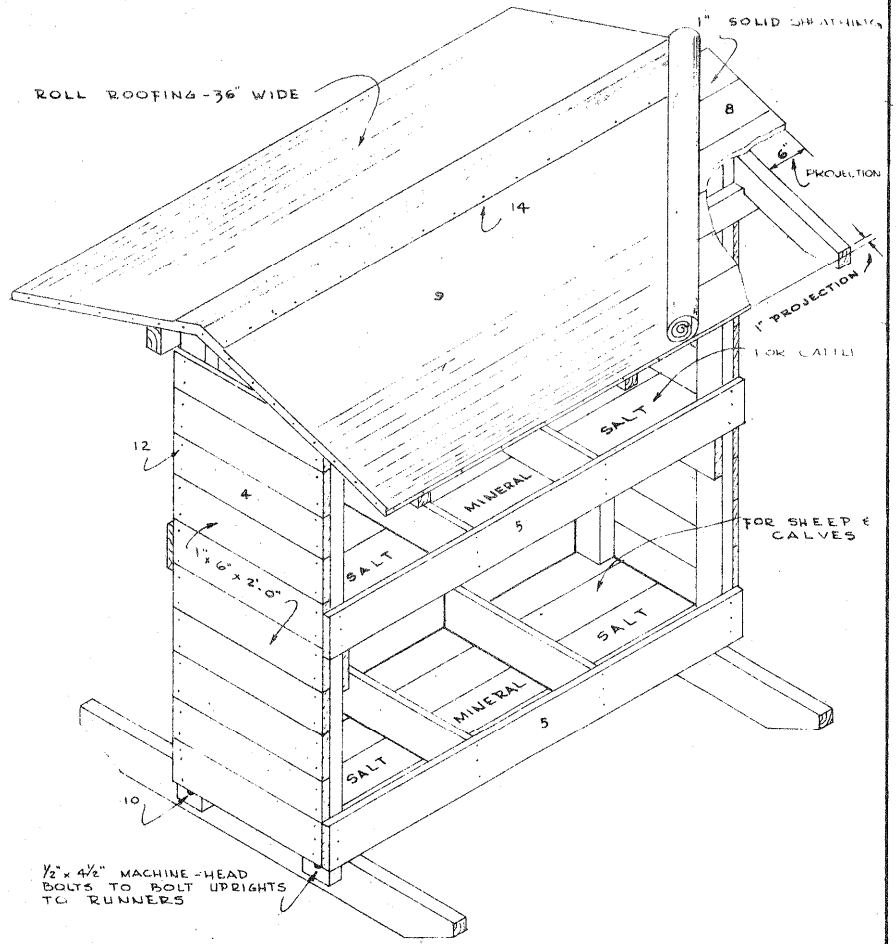
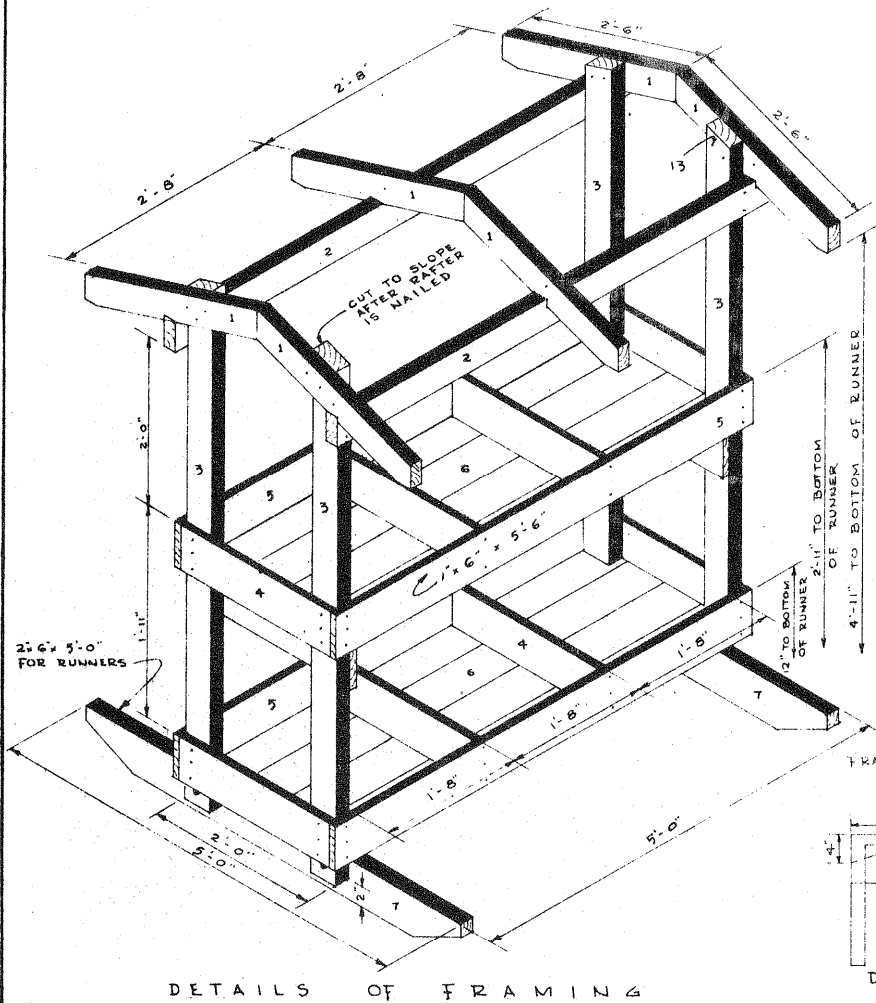

THIS PLAN DEVELOPED BY THE FARM SHOP SECTION OF THE AG. ENG. AND AG. ED. DEPT.

COOPERATIVE EXTENSION WORK IN AGRICULTURE AND HOME ECONOMICS DEPARTMENT OF AGRICULTURAL ENGINEERING UNIVERSITY OF MARYLAND

SALT AND MINERAL BOX

VA 52 EX 5769 SHEET 1 OF 1

Note: This archival plan is provided as a study plan only and may not be suitable for construction without modification, and may not be appropriate for all locales. Code officials and other authorities should always be consulted before any construction is attempted.